

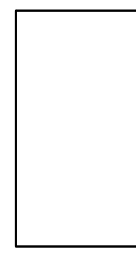

# LAYOUT PLAN OF I.P KONDAPUR, IN SY.NO:129 & 132 AT KONDAPUR VILLAGE, MANOHARABAD(M), MEDAK (DISTRICT), TELANGANA.

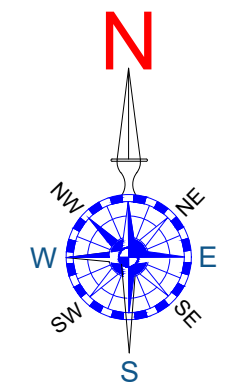
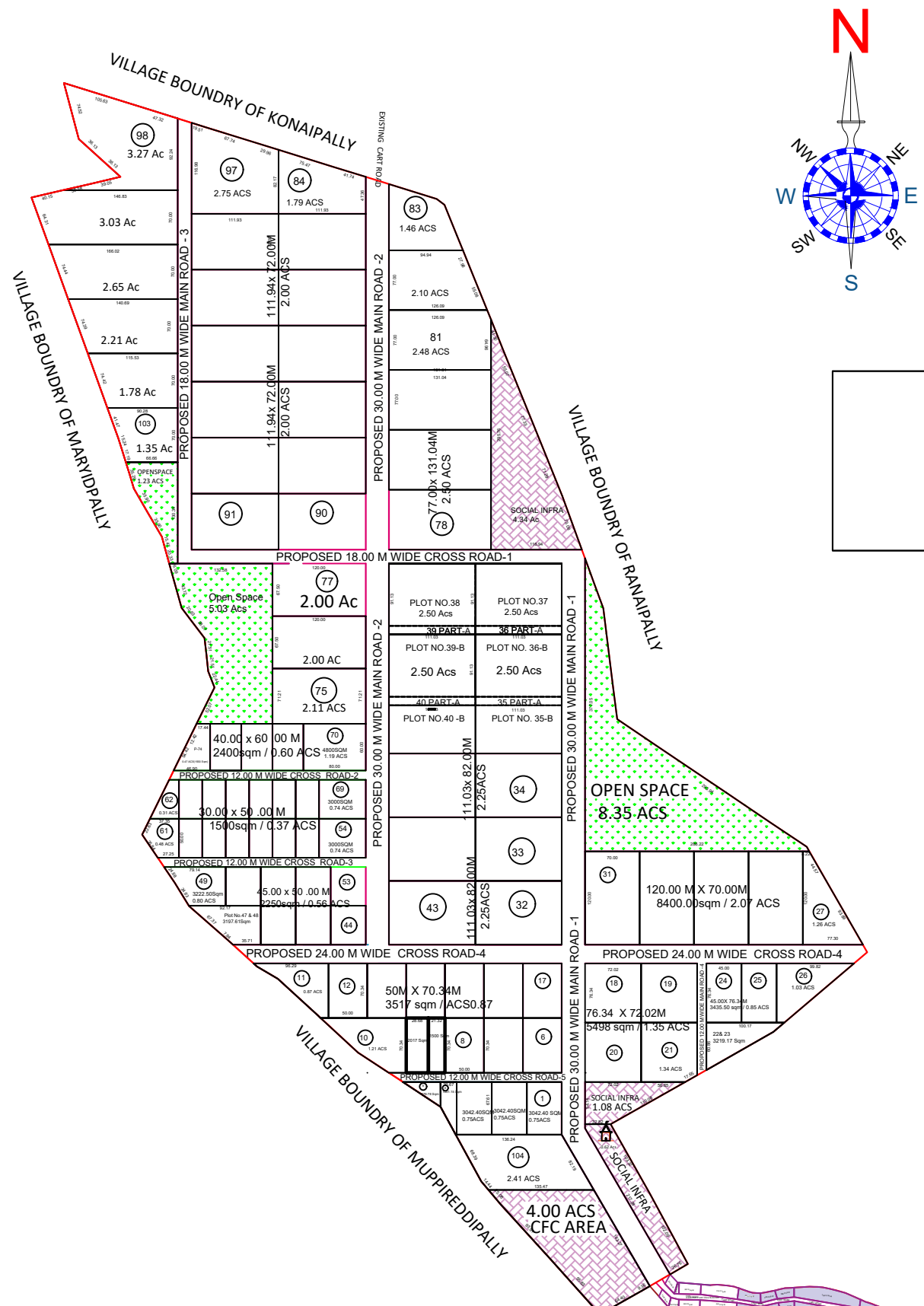

### LAND USE ANALYSIS:

- LAYOUT BOUNDARY
- PLOTS
- ROADS
- OPEN AREA
- SOCIAL INFRA & CFC

1	TOTAL AREA:	191.05 ACS	100%
2	PLOTTED AREA:	139.40 ACS	72.96%
3	ROAD AREA:	26.03 ACS	13.64%
4	OPEN AREA	14.62 ACS	07.65%
5	SOCIAL INFRA	7.00 ACS	03.66%
6	C.F.C AREA	04.00 ACS	02.09%
	NO. OF PLOTS	104	

APPROACH ROAD - 1



DY.ZONAL MANAGER(E)  
MDCL- SDPT ZO

ZONAL MANAGER  
MDCL- SDPT ZO

THE CHIEF ENGINEER  
TSIIC LTD