

T.S.I.I.C. LTD HYDERABAD

REVISED LAYOUT PLAN FOR
 INDUSTRIAL PARK (PH-11) IN SURVEY NO'S
 84, 86 (P),78(P),124(P), 125(P) &126 (P), 127(P),85, &132/2
 SITUATED AT BUCHINELLY VILLAGE , ZAHEERABAD
 MANDAL, SANGAREDDY -DISTRICT,
 TELANGANA.

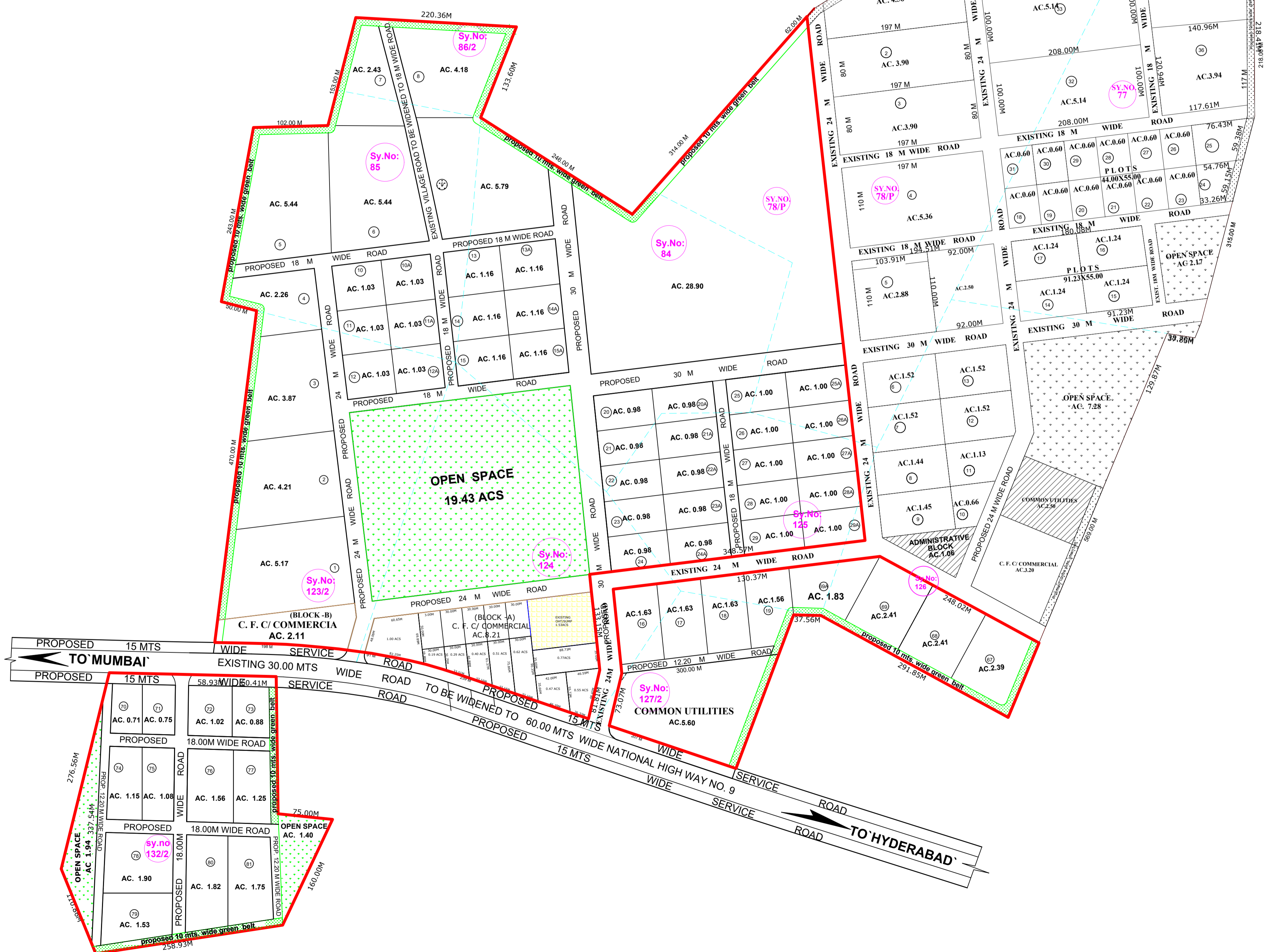

LAND USE ANALYSIS

LAYOUT BOUNDARY :		
EXISTING ROADS :		
PROPOSED ROADS :		
TOTAL LAYOUT AREA	191.91 AC	100.00%
PLOTTED AREA :	132.61 AC	69.10%
ROADS AREA :	20.52 AC	10.69%
OPEN SPACE AREA	22.77 AC	11.86%
C F C/ COMMERCIAL	08.88 AC	4.63%
COMMON UTILITIES	7.13 AC	3.72%

(ADMINISTRATIVE BLOCK,
 WATER WORKS CETP/STP,
 FIRE STATION,POLICE STATION,
 BUS SHELTER,
 SOCIAL WELFARE CENTRE)

Dy. Zonal Manager (E)

Zonal Manager